

RS2ABF thru RS2MABF

Surface Mount Glass Passivated Super Fast Rectifiers

Reverse Voltage 50 to 1000V Forward Current 2.0A

FEATURES

- * Plastic package has Underwriters Laboratory Flammability Classification 94V-0
- * High temperature metallurgically bonded construction
- * Cavity-free glass passivated junction
- * Capable of meeting environmental standards of MIL-S-19500
- * Fast Switching for high efficiency
- * Typical IR less than 1.0 μ A
- * High temperature soldering guaranteed: 260°C/10 seconds

Terminals: Plated leads, solderable per

Case: JEDEC SMB-FL, molded plastic over glass die

Terminals: Plated leads, solderable per MIL-STD-750, Method 2026

Polarity: Color band denotes cathode end

Mounting Position: Any

Weight: 0.066 g

Handling precaution: None

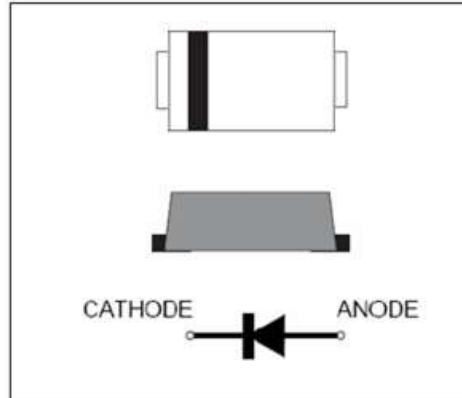

we declare that the material of product is halogen free (green epoxy compound).

1. Maximum & Thermal Characteristics Ratings at 25°C ambient temperature unless otherwise specified.

Parameter Symbol	symbol	RS2ABF	RS2BBF	RS2DBF	RS2GB _F	RS2JBF	RS2KBF	RS2MB _F	RS2MPBF	Unit
Device marking code		RS2A	RS2B	RS2D	RS2G	RS2J	RS2K	RS2M	RS2MP	
Maximum repetitive peak reverse voltage	V _{RRM}	50	100	200	400	600	800	1000	1000	V
Maximum RSM voltage	V _{RSM}	35	70	140	280	420	560	700	700	V
Maximum DC blocking voltage	V _{DC}	50	100	200	400	600	800	1000	1000	V
Maximum average forward rectified current 0.375" (9.5mm) lead length at T _C = 75°C	IF(AV)	2.0								A
Peak forward surge current 8.3ms single half sine-wave superimposed on rated load (JEDEC Method)	I _{FSM}	70								A
Typical thermal resistance (Note 2)	R θ JA	135								°C/W
	R θ JC	25								
Operating junction and storage temperature range	T _J , T _{STG}	-50 to +150								°C

Electrical Characteristics Ratings at 25°C ambient temperature unless otherwise specified.

Parameter Symbol	symbol	RS2ABF	RS2BBF	RS2DBF	RS2GB _F	RS2JBF	RS2KBF	RS2MB _F	RS2MPBF	Unit
Maximum instantaneous forward voltage at 2.0A	V _F	1.3								V
Maximum DC reverse current I _R = 25°C at rated DC blocking voltage T _J = 125°C	I _R	5.0								μ A
		100								
Typical reverse recovery time (Note 1)	trr	150				500		250		ns
Typical junction capacitance at 4.0V, 1MHz	C _J	8.0								PF

NOTES:

1. IF = 0.5A, IR = 1.0A, IRR = 0.25A
2. 8.0mm² (.013mm thick) land areas

RS2ABF thru RS2MABF

2. Ratings and Characteristic Curves (TA = 25°C unless otherwise noted)

Fig. 1 - Forward Current Derating Curve

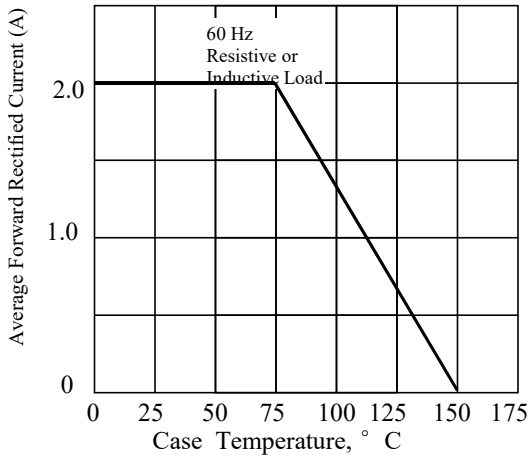

Fig. 2 - Maximum Non-repetitive Peak Forward Surge Current

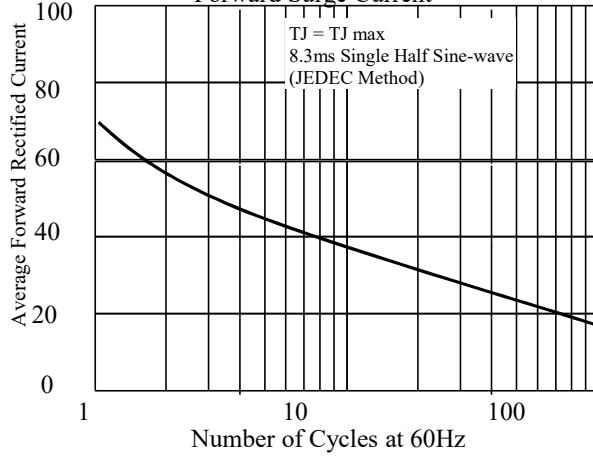

Fig 3 - Typical Instantaneous Forward Characteristics

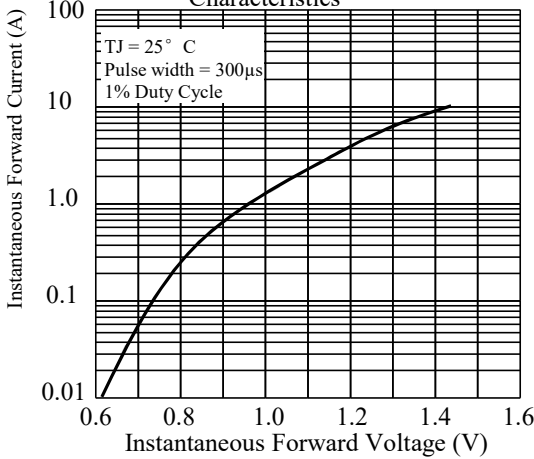

Fig 4 - Typical Reverse Characteristics

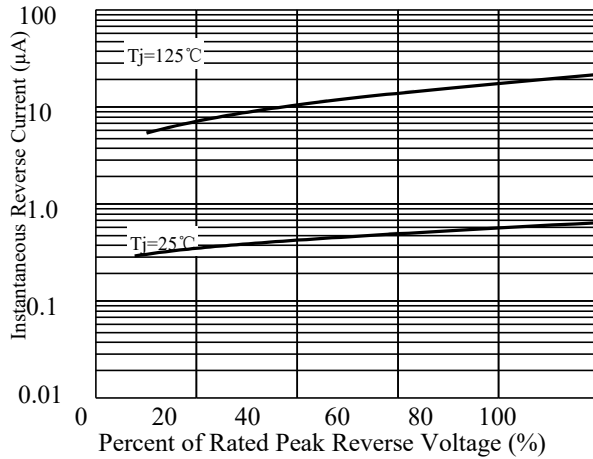

Fig 5 - typical transient thermal impedance

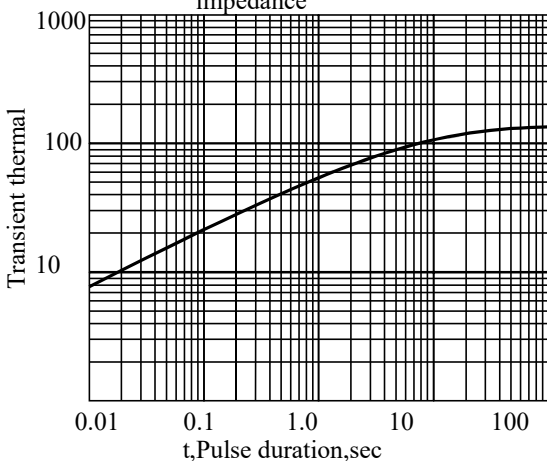
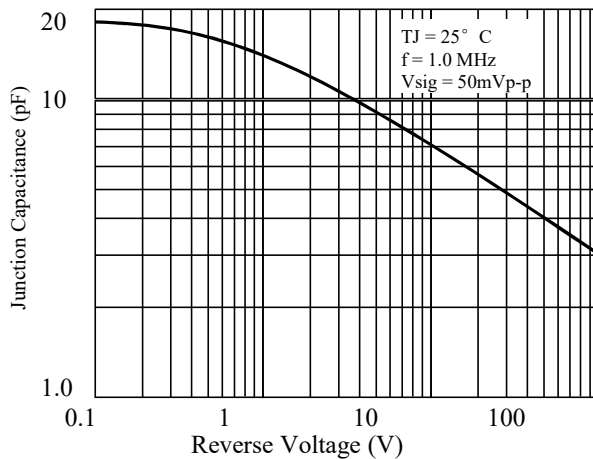

Fig 6 - Typical Junction Capacitance



RS2ABF thru RS2MABF

3. dimension:

SMB-FL

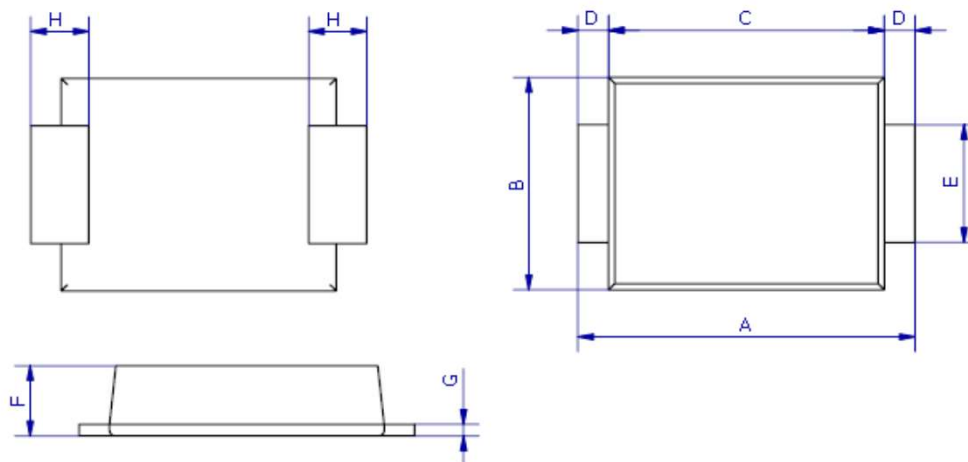

DIM	MILLIMETERS		INCHES	
	MIN	MAX	MIN	MAX
A	5.3	5.7	0.209	0.224
B	3.4	3.8	0.134	0.150
C	4.3	4.7	0.169	0.185
D	0.45Typ		0.018Typ	
E	1.9	2.1	0.0748	0.08268
F	1.05	1.40	0.04134	0.05512
G	0.2	0.3	0.00591	0.00984
H	0.95Typ		0.037Typ	

Mounting Pad Layout

--- SMB-FL

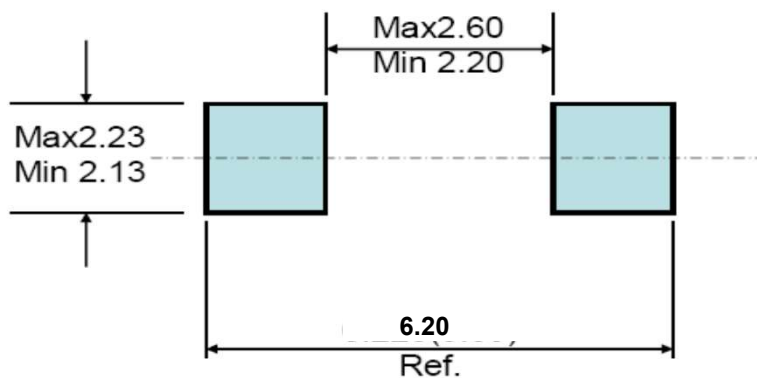

RS2ABF thru RS2MABF

4. Update Record

版次	更新记录	更新作者	更新日期
1	第一版	周杰	2014. 04. 30