

金属化聚丙烯膜灯具电容器 Metallized polypropylene film capacitor for lamps

■ 外形图 Outline Drawing

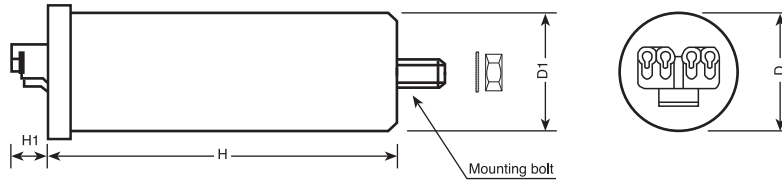

■ 特点

广泛用于荧光灯、高压汞灯、钠灯、金属卤素灯等以频率为50Hz/60Hz的交流电源供电的照明灯具中的变压器、电子镇流器的功率因数补偿，使灯具的功率因数 $\cos\varphi \geq 0.9$ 。

■ Features

The capacitors are designed for lighting applications such as fluorescent lamps, high-pressure mercury vapor lamps, sodium lamps, and metal halide lamps. The capacitors are used for power factor compensation of transformers and magnetic ballasts in lamps with a frequency of 50 or 60Hz, which makes the power factor to achieve $\cos\varphi \geq 0.9$.

■ 安全认证 Safety Approvals

●		CQC (中国)	GB/T 18489-2008, type A, 2.0 μ F ~ 50.0 μ F, 250Vac, 50/60Hz, -40°C/85°C 证书号(Certificate No.): CQC04000009201
●		TUV Rheinland (德国)	EN 61048:2006, type A, 2.0 μ F ~ 50.0 μ F, 250Vac, 50/60Hz, -40°C/85°C 证书号(Certificate No.): R 50160499

■ 技术要求 Specifications

引用标准 Reference Standard	GB/T 18489-2008(IEC 61048:2006) GB/T 18504-2001 (IEC 61049:1991)
额定电压 Rated Voltage (U_n)	250Vac
额定频率 Rated Frequency (f_n)	50/60Hz
容量范围 Capacitance Range (C_n)	2.0 μ F ~ 50.0 μ F
容量等级 Capacitance Tolerance	$\pm 5\%$, $\pm 10\%$
额定最高温度(电容器表面温度, t_c) Rated Max. Temperature (on capacitor surface, t_c)	85°C
气候类别 Climatic Category	40/85/10
电容器类别 Type	Type A (self-healing parallel capacitor)
外壳类型 Case	Plastic or Aluminum
凝露 Condensation	Not permitted
耐电压(引线之间) Test Voltage Between Terminals	500Vac, 2s
耐电压(极壳之间) Test Voltage Between Terminals to Case	2 000Vac, 2s (max. leakage current: 0.5mA)
最高工作电压 Max. Operating Voltage	275Vac
额定电流 Rated Current (I_n)	0.0785 C_n (A) @ 50Hz 0.0942 C_n (A) @ 60Hz (Unit of C_n : μ F)
最大工作电流 Max. Operating Current	1.3 I_n
外壳防护等级 Degree of protection	IP00
电极端子 Terminals	Push in connector or insulated wires
连接线 Connecting Wires	Insulated rigid leads 0.5~1.0mm ² , approx. stripped 6~7mm
底部固定螺栓 Bottom Mounting bolts	M8
最大安装扭矩 Max. Torque of Installation	3N·m
最高使用海拔 Max Altitude	2 000m



产品编码说明 Part number system

■ 18位产品代码如下：

The 18 digits part number is formed as follow:

1	2	3	4	5	6	7	8	9	10	11	12	13	14	15	16	17	18
C	6	2															

第1~3位	型号代码	Digit 1 to 3	Series code
	C62=CBB60L		C62=CBB60L
第4~5位	交流额定电压	Digit 4 to 5	AC rated voltage
	E2=250V		E2=250V
第6~8位	标称容量	Digit 6 to 8	Rated capacitance value
	举例：505=50 × 10 ⁵ pF=5.0μF		For example : 505=50 × 10 ⁵ pF=5.0μF
第9位	容量偏差	Digit 9	Capacitance tolerance
	K= ± 10%		K= ± 10%
第10位	产品外形尺寸代码	Digit 10	Dimension code

CBB60L Dimension code					
D	H	Code	D	H	Code
25	58	1	45	100	8
30	58	2	45	125	9
30	68	3	45	66	A
30	73	4	45	95	B
30	98	5	25	53	C
35	95	6	35	73	D
40	95	7			

第11位	内部特征码	Digit 11	Internal use
第12~15位	引出端代码	Digit 12 to 15	Terminals code
第16~18位	内部特征码	Digit 16 to 18	Internal use

■ **Table 1 引出端代码 Terminals code**

第 12 位 Digit 12		第 13 位 Digit 13		第 14 位 Digit 14		第 15 位 Digit 15	
Code	引出端形式 Terminal form	Code	安装形式 Fixed style	Code	引出端长度 length of lead wire	Code	是否有放电电阻 With or without discharger resistor
B	UL1015 绝缘线 剥线式 UL1015 insulated lead wire	5 8	下部螺栓 M8 Bottom-bolt M8 中部卡圈 Ring-clip in the middle of case	0 8	标准长度 standard length 8 英寸 8 inch (1 inch=25.4mm)	R	With resistor
						0	Without resistor
G	插入式端子 insert terminal						

■ 外形尺寸 Dimensions (mm)

250Vac								250Vac (Miniature Version)							
C _n (μF)	D ±2.0	D1 ±2.0	H ±3.0	H1 ±1.0	Mounting bolt	Discharge resistor	Part number	C _n (μF)	D ±2.0	D1 ±2.0	H ±3.0	H1 ±1.0	Mounting bolt	Discharge resistor	Part number
2.0	25	25	58	12	M8 x 10	0.5W,1.2MΩ	C62E2205-10****+++	2.0	25	25	53	12	M8 x 10	0.5W,1.2MΩ	C62E2205-C0****+++
2.5	25	25	58	12	M8 x 10	0.5W,1.2MΩ	C62E2255-10****+++	2.5	25	25	53	12	M8 x 10	0.5W,1.2MΩ	C62E2255-C0****+++
3.0	25	25	58	12	M8 x 10	0.5W,1.2MΩ	C62E2305-10****+++	3.0	25	25	53	12	M8 x 10	0.5W,1.2MΩ	C62E2305-C0****+++
3.5	25	25	58	12	M8 x 10	0.5W,1.2MΩ	C62E2355-10****+++	3.5	25	25	53	12	M8 x 10	0.5W,1.2MΩ	C62E2355-C0****+++
4.0	25	25	58	12	M8 x 10	0.5W,1.2MΩ	C62E2405-10****+++	4.0	25	25	53	12	M8 x 10	0.5W,1.2MΩ	C62E2405-C0****+++
4.5	25	25	58	12	M8 x 10	0.5W,1.2MΩ	C62E2455-10****+++	4.5	25	25	53	12	M8 x 10	0.5W,1.2MΩ	C62E2455-C0****+++
5.0	25	25	58	12	M8 x 10	0.5W,1.2MΩ	C62E2505-10****+++	5.0	25	25	53	12	M8 x 10	0.5W,1.2MΩ	C62E2505-C0****+++
5.5	30	29	58	12	M8 x 10	0.5W,1.2MΩ	C62E2555-20****+++	5.5	25	25	53	12	M8 x 10	0.5W,1.2MΩ	C62E2555-C0****+++
6.0	30	29	58	12	M8 x 10	0.5W,1.2MΩ	C62E2605-20****+++	6.0	25	25	58	12	M8 x 10	0.5W,1.2MΩ	C62E2605-10****+++
6.3	30	29	58	12	M8 x 10	0.5W,1.2MΩ	C62E2635-20****+++	6.3	25	25	58	12	M8 x 10	0.5W,1.2MΩ	C62E2635-10****+++
6.5	30	29	58	12	M8 x 10	0.5W,1.2MΩ	C62E2655-20****+++	6.5	25	25	58	12	M8 x 10	0.5W,1.2MΩ	C62E2655-10****+++
7.0	30	29	58	12	M8 x 10	0.5W,1.2MΩ	C62E2705-20****+++	7.0	25	25	58	12	M8 x 10	0.5W,1.2MΩ	C62E2705-10****+++
7.5	30	29	58	12	M8 x 10	0.5W,1.2MΩ	C62E2755-20****+++	7.5	30	27	58	12	M8 x 10	0.5W,1.2MΩ	C62E2755-20****+++
8.0	30	29	68	12	M8 x 10	0.5W,1.2MΩ	C62E2805-30****+++	8.0	30	27	58	12	M8 x 10	0.5W,1.2MΩ	C62E2805-20****+++
8.4	30	29	68	12	M8 x 10	0.5W,1.2MΩ	C62E2845-30****+++	8.4	30	27	58	12	M8 x 10	0.5W,1.2MΩ	C62E2845-20****+++
8.5	30	29	68	12	M8 x 10	0.5W,1.2MΩ	C62E2855-30****+++	8.5	30	27	58	12	M8 x 10	0.5W,1.2MΩ	C62E2855-20****+++
9.0	30	29	68	12	M8 x 10	0.5W,1.2MΩ	C62E2905-30****+++	9.0	30	29	58	12	M8 x 10	0.5W,1.2MΩ	C62E2905-20****+++
9.5	30	29	68	12	M8 x 10	0.5W,1.2MΩ	C62E2955-30****+++	9.5	30	29	58	12	M8 x 10	0.5W,1.2MΩ	C62E2955-20****+++
10	30	29	68	12	M8 x 10	0.5W,1.2MΩ	C62E2106-30****+++	10	30	29	58	12	M8 x 10	0.5W,1.2MΩ	C62E2106-20****+++
12	30	29	73	12	M8 x 10	0.5W,1.2MΩ	C62E2126-40****+++	12	30	29	68	12	M8 x 10	0.5W,1.2MΩ	C62E2126-30****+++
12.5	30	29	98	12	M8 x 10	0.5W,1.2MΩ	C62E212E-50****+++	12.5	30	29	68	12	M8 x 10	0.5W,1.2MΩ	C62E212E-30****+++
13	30	29	98	12	M8 x 10	0.5W,1.2MΩ	C62E2136-50****+++	13	30	29	68	12	M8 x 10	0.5W,1.2MΩ	C62E2136-30****+++
14	30	29	98	12	M8 x 10	0.5W,1.2MΩ	C62E2146-50****+++	14	30	29	68	12	M8 x 10	0.5W,1.2MΩ	C62E2146-30****+++
15	30	29	98	12	M8 x 10	0.5W,1.2MΩ	C62E2156-50****+++	15	30	29	73	12	M8 x 10	0.5W,1.2MΩ	C62E2156-40****+++
16	30	29	98	12	M8 x 10	0.5W,1.2MΩ	C62E2166-50****+++	16	30	29	73	12	M8 x 10	0.5W,1.2MΩ	C62E2166-40****+++
18	30	29	98	12	M8 x 10	0.5W,1.2MΩ	C62E2186-50****+++	18	35	33	73	12	M8 x 10	0.5W,1.2MΩ	C62E2186-D0****+++
20	35	34	95	12	M8 x 10	0.5W,1.2MΩ	C62E2206-60****+++	20	35	33	73	12	M8 x 10	0.5W,1.2MΩ	C62E2206-D0****+++
22	35	34	95	12	M8 x 10	0.5W,1.2MΩ	C62E2226-60****+++	22	30	29	98	12	M8 x 10	0.5W,1.2MΩ	C62E2226-50****+++
25	35	34	95	12	M8 x 10	0.5W,0.75MΩ	C62E2256-60****+++	25	30	29	98	12	M8 x 10	0.5W,0.75MΩ	C62E2256-50****+++
28	40	38	95	12	M8 x 10	0.5W,0.75MΩ	C62E2286-70****+++	28	35	33	95	12	M8 x 10	0.5W,0.75MΩ	C62E2286-60****+++
30	40	38	95	12	M8 x 10	0.5W,0.75MΩ	C62E2306-70****+++	30	35	33	95	12	M8 x 10	0.5W,0.75MΩ	C62E2306-60****+++
32	40	38	95	12	M8 x 10	0.5W,0.75MΩ	C62E2326-70****+++	32	35	33	95	12	M8 x 10	0.5W,0.75MΩ	C62E2326-60****+++
35	40	38	95	12	M8 x 10	0.5W,0.75MΩ	C62E2356-70****+++	35	35	34	95	12	M8 x 10	0.5W,0.75MΩ	C62E2356-60****+++
36	45	44	66	12	M8 x 10	0.5W,0.75MΩ	C62E2366-A0****+++	36	45	44	66	12	M8 x 10	0.5W,0.75MΩ	C62E2366-A0****+++
40	45	44	95	12	M8 x 10	0.5W,0.47MΩ	C62E2406-B0****+++	40	40	39	95	12	M8 x 10	0.5W,0.47MΩ	C62E2406-70****+++
45	45	45	100	16	M8 x 12	0.5W,0.47MΩ	C62E2456-80****+++	45	40	39	95	16	M8 x 12	0.5W,0.47MΩ	C62E2456-70****+++
50	45	45	125	16	M8 x 12	0.5W,0.47MΩ	C62E2506-90****+++	50	45	45	95	16	M8 x 12	0.5W,0.47MΩ	C62E2506-B0****+++

备注: 1. “-”表示容量偏差。 “-” =capacitance tolerance code, J=±5%, K=±10%。
 2. “****”表示引出端代码(见table 1)。“****” =terminals form code (refer to table 1)。
 3.其它容量、尺寸系列可按用户需要商定。Other values and dimensions are available on request.